

SITE NO.	AREA (SQM)
1	255.66
2	324.61
3	317.24
4	309.87
5	302.50
6	295.12
7	287.75
8	280.38
9	273.01
10	265.63
11	258.26
12	250.89
13	243.52
14	236.14
28	206.83
29	167.60
30	170.99
48	167.17
49	191.31
50	147.19
75	209.36
76	184.18
83	240.46
84	196.71
90	172.67
91	164.32
98	141.36
99	136.68
109	118.83
110	147.14
128	103.36
129	91.90
130	85.33
147	129.09
148	116.48
158	141.64
165	151.17
166	136.18
173	141.64
183	126.62
184	109.71
191	142.86
192	157.35
199	124.16
207	71.13
208	85.63
216	83.54
217	93.31
218	94.37
223	99.01
224	107.08
229	111.73
230	162.13
231	81.72
232	98.34
233	127.15
TOTAL	9636.01

PARK DIMENSIONS	
SL.NO	AREA IN SQ.M
PARK-1	2,880.01
PARK-2	1,799.49
PARK-3	1,840.17
TOTAL	6,519.67

CA DIMENSIONS	
SL.NO	AREA IN SQ.M
CA-1	1,750.04
CA-2	1,553.05
TOTAL	3,303.09

TOTAL PLOT DETAILS			
DIMENSION	SITE NUMBERS	TOTAL NO.	TOTAL AREA IN SQM
9.14M X 12.19M	131, 132, 133, 134, 135, 136, 137, 138, 139, 140, 141, 142, 143, 144, 145, 146, 149, 150, 151, 152, 153, 154, 155, 156, 157, 159, 160, 161, 162, 163, 164, 167, 168, 169, 170, 171, 172, 174, 175, 176, 177, 178, 179, 180, 181, 182, 185, 186, 187, 188, 189, 190, 193, 194, 195, 196, 197, 198, 200, 201, 202, 203, 204, 205, 206, 209, 210, 211, 212, 213, 214, 215, 219, 220, 221, 222, 225, 226, 227, 228	80	8,913.32
9.14M X 15.24M	51, 52, 53, 54, 55, 56, 57, 58, 59, 60, 61, 62, 63, 64, 65, 66, 67, 68, 69, 70, 71, 72, 73, 74, 92, 93, 94, 95, 96, 97, 100, 101, 102, 103, 104, 105, 106, 107, 108, 111, 112, 113, 114, 115, 116, 117, 118, 119, 120, 121, 122, 123, 124, 125, 126, 127	56	7,800.44
12.19M X 18.29M	15, 16, 17, 18, 19, 20, 21, 22, 23, 24, 25, 26, 27, 31, 32, 33, 34, 35, 36, 37, 38, 39, 40, 41, 42, 43, 44, 45, 46, 47, 77, 78, 79, 80, 81, 82, 85, 86, 87, 88, 89	41	9,141.16
ODD SITES*	1, 2, 3, 4, 5, 6, 7, 8, 9, 10, 11, 12, 13, 14, 28, 29, 30, 48, 49, 50, 75, 76, 83, 84, 90, 91, 98, 99, 109, 110, 128, 129, 130, 147, 148, 158, 165, 166, 173, 183, 184, 191, 192, 199, 207, 208, 216, 217, 218, 223, 224, 229, 230, 231, 232, 233	56	9,636.01
TOTAL		233	35,490.93

CONVERSION ORDER NOS.						
SL.NO	VILLAGE NAME	SY.NO	TOTAL EXTENT			CONVERSION ORDER NUMBER
			Acres	Guntas	Kharab	
1	KAMENAHALLI	30	03	38	00	AN/01/SR/53/1996-97 Dt:1-10-1997
2		129	02	20	00	AN/01/SR/53/1996-97 Dt:1-10-1997
3		130	02	16	00	AN/01/SR/53/1996-97 Dt:1-10-1997
4		137	03	28	12	AN/01/SR/53/1996-97 Dt:1-10-1997
5		138	03	30	10	AN/01/SR/53/1996-97 Dt:1-10-1997
TOTAL AREA			16	12	22	

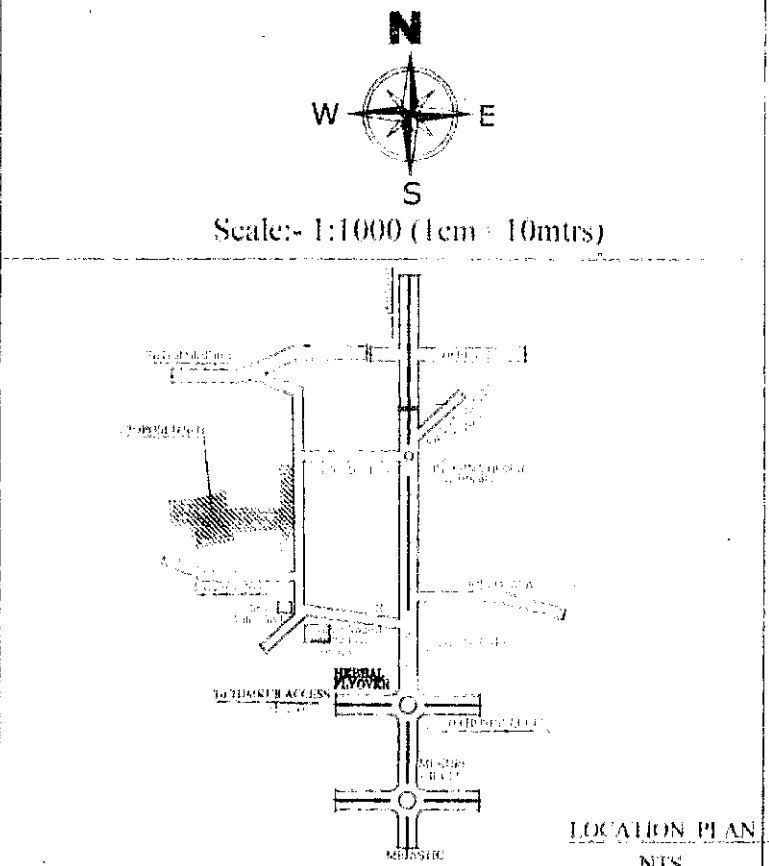

LEGENDS:	
LAYOUT BOUNDARY	---
REVENUE BOUNDARY	---
OVER HEAD TANK	(OHT)
SEWERAGE TREATMENT PLANT	(STP)

AREA STATEMENT:					
SL.NO	VILLAGE NAME	SY.NO	TOTAL EXTENT		
			Acres	Guntas	Kharab
1	KAMENAHALLI	30	03	38	00
2		129	02	20	00
3		130	02	16	00
4		137	03	28	12
5		138	03	30	10
TOTAL AREA			16	12	22

AS per conversion order the area is 16 Acre 12Guntas but Physical Boundary is 16Acre 02 Guntas (less by 10 guntas) Area Considered For Layout 16 Acres 02 Guntas (64,951.14 Sqm)

LAND USE ANALYSIS:			
SL.NO	DESCRIPTION	AREA IN SQMT	%
1	RESIDENTIAL	35,490.93	54.64
2	PARKS	6,519.67	10.04
3	CA	3,303.09	5.09
4	ROADS	19,637.45	30.23
TOTAL		64,951.14	100.00

TITLE:
PROPOSED RESIDENTIAL LAYOUT PLAN IN AT SY NO.30,129,130,137 & 138 OF KAMENAHALLI VILLAGE, KUNDANA HOBLI DEVANAHALLI TALUK

OWNER:
PRESIDENT
BSNL Employee's Welfare House Building Society Ltd, B'lore.
BSNL EMPLOYEES HOUSE BUILDING CO-OP SOCIETY LTD

DEVELOPED BY:
SRUTHI ENCLAVE

ENGINEER:
BASAVYA S.K
BCC/BL/65-1415/2014-15
Oneness InfraTech
#99, 2nd Floor, 59th Cross, 5th Block,
Near Bhasyan Circle, Rajajinagar,
Bangalore-560 010
Tel: 080-41141611 Email: info@onenessinfra.com
www.onenessinfra.com

SANCTIONING AUTHORITY

ಕರ್ನಾಟಕ ನಗರ ಮತ್ತು ಗ್ರಾಮಾಂತರ ಯೋಜನಾ ಕಾಯ್ದೆ 1961 ರ ಕೆಲವು 17 ರನ್ಯಾಯ ಹಾಗೂ ದಿನಾಂಕ : 25-06-2014 ರಂದು ನಡೆದ ಪ್ರಾಥಮಿಕ ಕಾರ್ಯದ ವಿಷಯ ಸಂಖ್ಯೆ 100/3/00 ರಲ್ಲಿನ ನಿರ್ಣಯದನ್ವಯ, ಪ್ರಾಥಮಿಕ ಮತ್ತು ಸಂಖ್ಯೆ: ಬಿಎಎಚ್‌ಎ/ಟಿಎ/ಎ/ಎಂ/288/2014-15 ದಿನಾಂಕ : 27-01-2016 ರಲ್ಲಿನ ಸರಕುಗಳ ನಿರ್ವಹಣೆ ದಿನಾಂಕ : 27-01-2016 ರಿಂದ ದಿನಾಂಕ 28-01-2016 ವರೆಗೆ ಎಲ್ಲಾ ವರ್ತಮಾನ ಅಧಿಕಾರಿಗಳಿಗೆ ಅನುಮೋದನೆನ್ನು ನೀಡಲಾಗಿದೆ.
ಸದಸ್ಯ ಕಾರ್ಯದರ್ಶಿ,
ನಗರಪಾಲಿಕೆ ಅಂತರ ರಾಜ್ಯೀಯ ವಿವಾಸ ನಿರ್ಮಾಣ ಪ್ರಯೋಜನ ಪ್ರಾಧಿಕಾರ,
ಕುಂದನಾಹಳ್ಳಿ 27-1-16

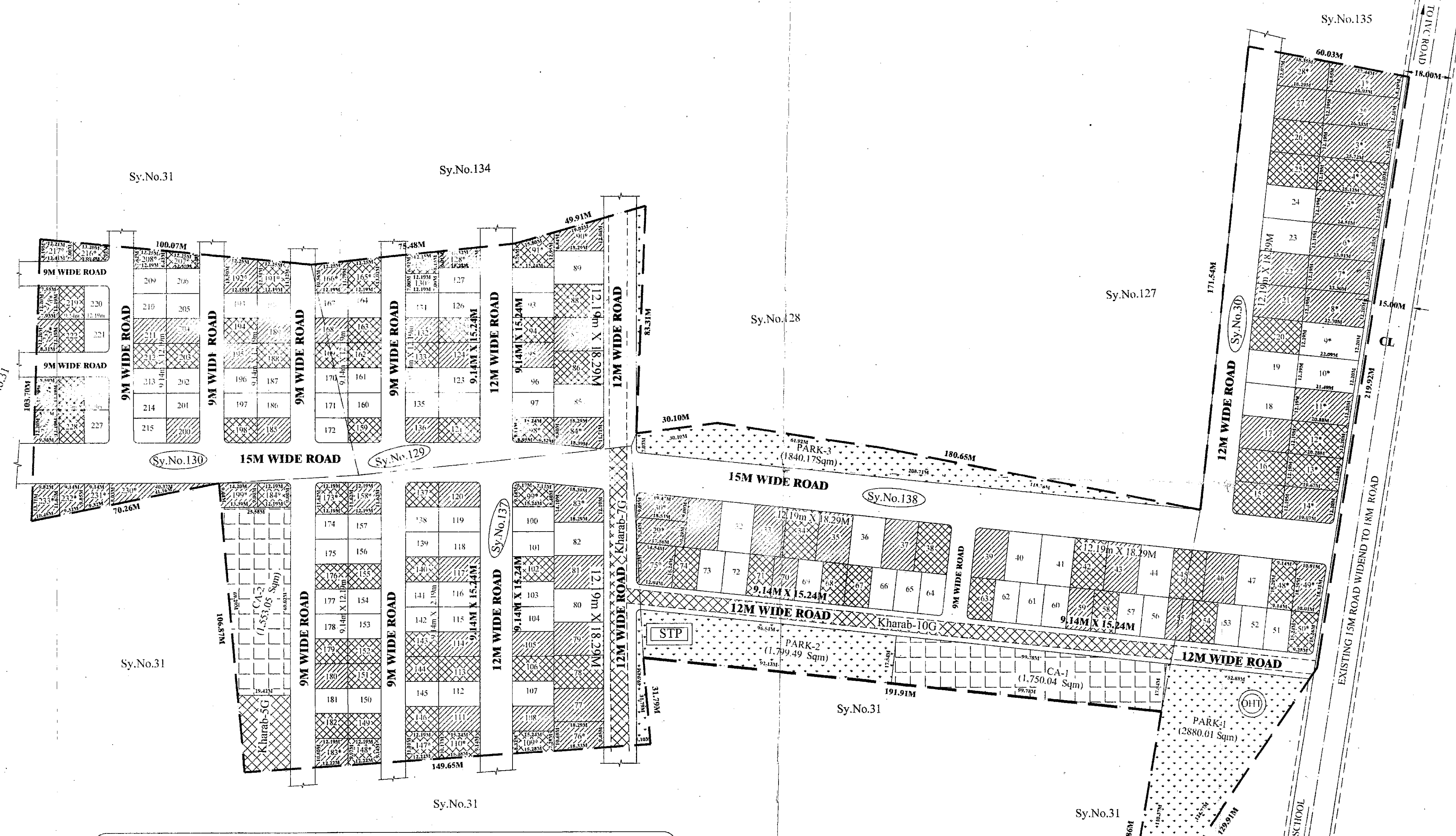

40% OF THE SITES RELEASED FOR REGISTRATION			
DIMENSION	SITE NUMBERS	TOTAL NO.	TOTAL AREA IN SQM
9.14M X 12.19M	131, 134, 135, 138, 139, 141, 142, 145, 150, 153, 154, 156, 157, 160, 161, 164, 167, 170, 171, 172, 174, 175, 177, 178, 181, 186, 187, 190, 193, 196, 197, 201, 202, 205, 206, 209, 210, 213, 214, 215, 220, 221, 226, 227	44	4,902.33
9.14M X 15.24M	51, 52, 53, 56, 57, 60, 61, 62, 64, 65, 66, 69, 72, 73, 92, 93, 96, 97, 100, 101, 103, 104, 107, 112, 115, 116, 118, 119, 122, 123, 126, 127	32	4,457.39
12.19M X 18.29M	18, 19, 23, 24, 32, 36, 40, 41, 44, 47, 80, 82, 85, 89	14	3,121.37
ODD SITES*	9, 10, 130	03	623.97
TOTAL		93	13,105.06

30% OF THE SITES RETAINED WITH BIAAPA (BLOCK-I) WILL BE THE			
DIMENSION	SITE NUMBERS	TOTAL NO.	TOTAL AREA IN SQM
9.14M X 12.19M	133, 137, 140, 143, 144, 146, 149, 151, 152, 155, 159, 162, 163, 169, 176, 179, 182, 188, 194, 198, 203, 212, 219, 222, 225, 228	26	2,896.83
9.14M X 15.24M	54, 58, 63, 67, 68, 71, 74, 94, 102, 106, 113, 121, 125	13	1,810.82
12.19M X 18.29M	15, 16, 20, 25, 26, 34, 38, 42, 45, 78, 86, 88	12	2,675.46
ODD SITES*	4, 12, 13, 48, 50, 91, 98, 99, 109, 110, 129, 147, 148, 165, 173, 184, 191, 207, 216	19	2,864.49
TOTAL		70	10,247.60

30% OF THE SITES RETAINED WITH BIAAPA (BLOCK-II) WILL BE RELEASED AFTER COMPLETION OF ALL WORKS			
DIMENSION	SITE NUMBERS	TOTAL NO.	TOTAL AREA IN SQM
9.14M X 12.19M	132, 136, 168, 180, 185, 189, 195, 200, 204, 211	10	1,114.16
9.14M X 15.24M	55, 59, 77, 95, 105, 108, 111, 114, 117, 120, 124	11	1,532.23
12.19M X 18.29M	17, 21, 22, 27, 31, 33, 35, 37, 39, 43, 46, 77, 79, 81, 87	15	3,344.33
ODD SITES*	1, 2, 3, 5, 6, 7, 8, 11, 14, 28, 29, 30, 49, 75, 76, 83, 84, 90, 138, 158, 166, 183, 192, 199, 208, 217, 218, 223, 224, 229, 230, 231, 232, 233	34	6,147.55
TOTAL		70	12,138.27